

**Port-O-Bender® Table™**  
 for PRO Series, PRO 2000 and MAX-I-MUM II Brakes

**Set-Up**

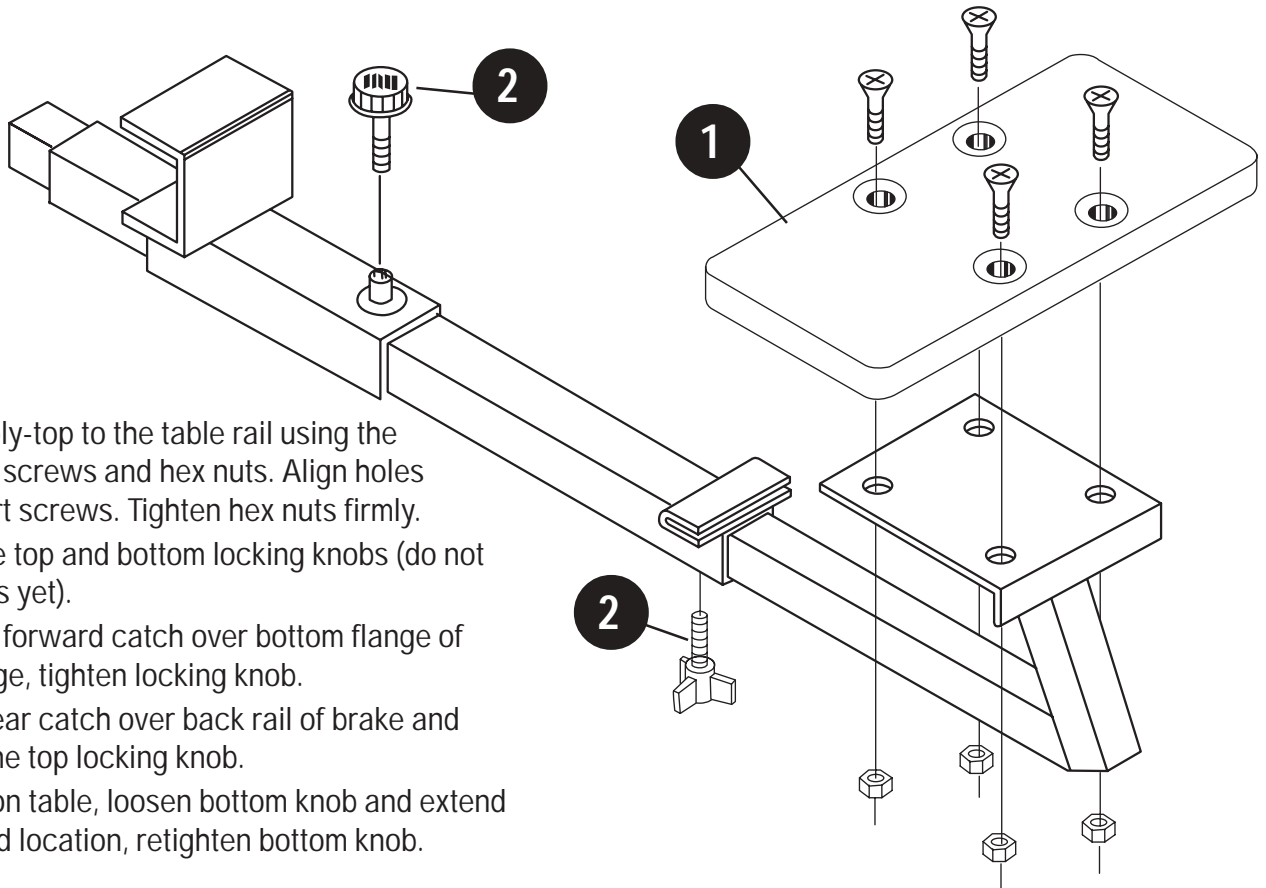

**Steps**

1. Install poly-top to the table rail using the flat head screws and hex nuts. Align holes and insert screws. Tighten hex nuts firmly.
2. Insert the top and bottom locking knobs (do not tighten as yet).
3. Slide the forward catch over bottom flange of base hinge, tighten locking knob.
4. Extend rear catch over back rail of brake and tighten the top locking knob.
5. To position table, loosen bottom knob and extend to desired location, retighten bottom knob.

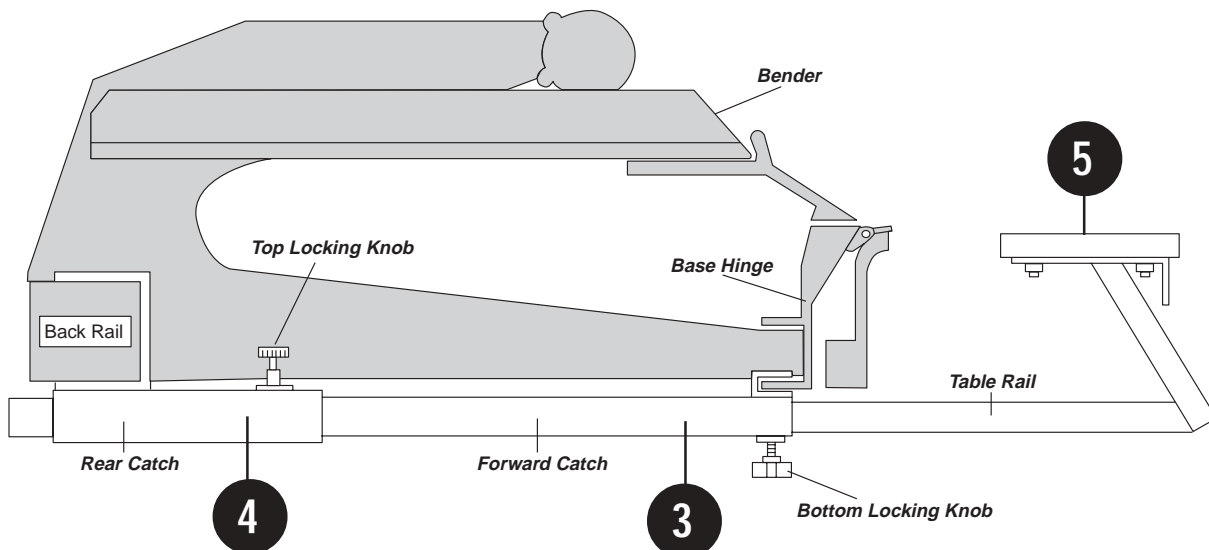

# Operation

---

## Typical Use

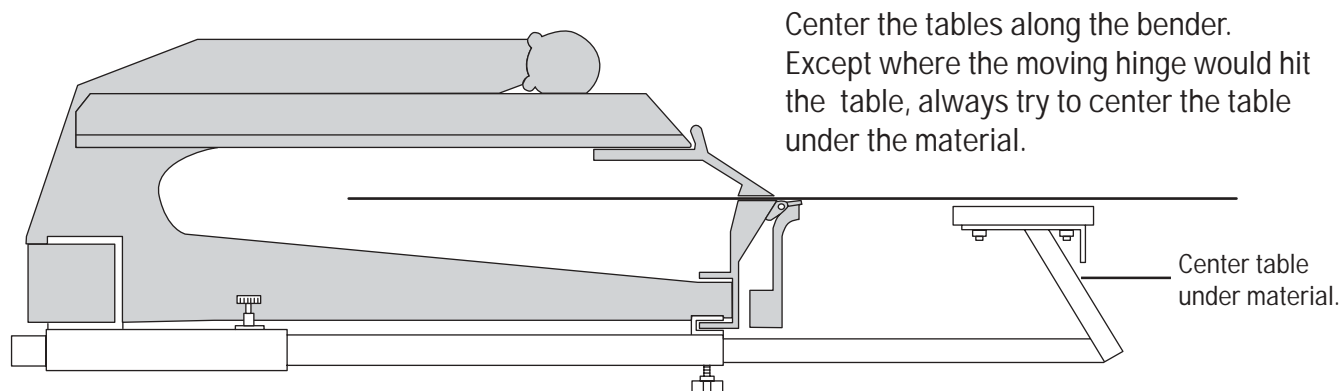

## Optional Use

To use tables for storing material to the rear area of the brake, loosen the bottom locking knob. Next slide the table out from the front of the brake and reinstall from the rear. Retighten knob.

**CAUTION:** Table does not tighten from this position. do not overload table.

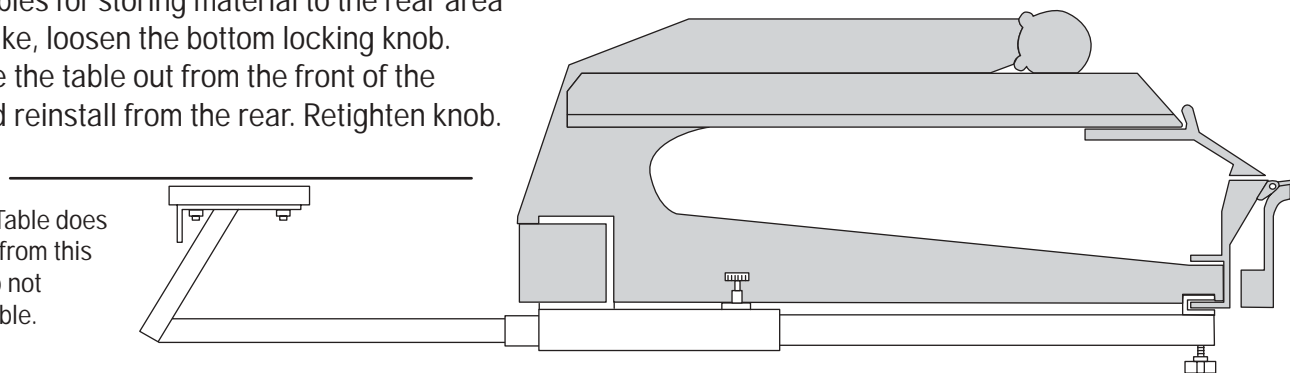

## Making Compound Bends

**NOTE:** When making compound bends, you may have to remove the table. Simply loosen the bottom locking knob, remove table and set aside.

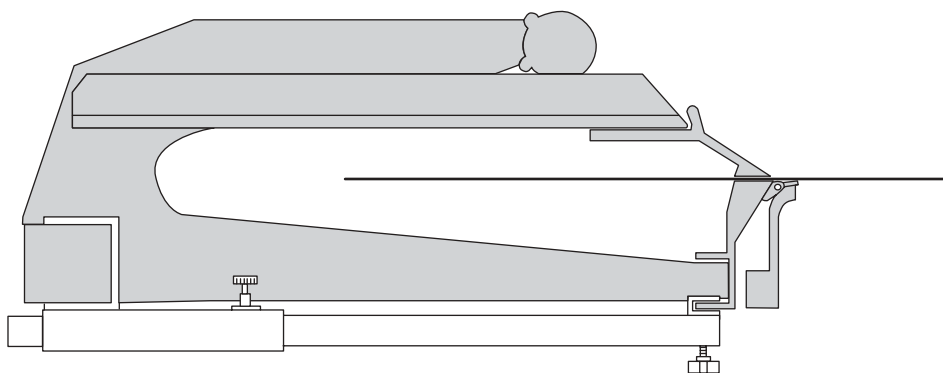

**TAPCO PRODUCTS COMPANY**  
*A DIVISION OF TAPCO INTERNATIONAL*

29797 Beck Road • Wixom, MI 48393-2834  
[www.tapcoint.com](http://www.tapcoint.com)